

NEUTRAL TOP ELEMENT WITH 2 DRAWERS

CODICE
BN12130215

MODELLO
1100/45TENC

SERIE
SERIE 1100

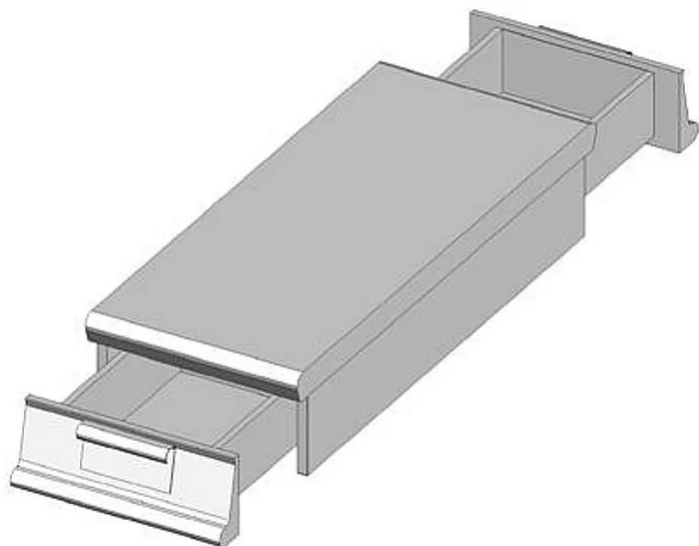

GENERAL CHARACTERISTICS

A complete range that stands out for its exceptional versatility and the perfect combination of modules, thanks to the use of laser cutting technology.

The 1100 Series makes it possible to create different combinations and to equip the base units with a variety of solutions: central cooking blocks on bases, on bridges and even suspended; free-standing and therefore more functional pasta cookers and fryers. All in a structure that is both sturdy and design at the same time.

AISI 304 stainless steel, Scotch Brite finish, laser-cut 2 mm thick worktops

Wide choice of burners with different power ranges (3.5Kw, 5.6 Kw, 7 Kw, 10Kw)

Burners with stabilised flame, nickel-plated cast iron

Virtually unlimited possibility of power combinations (in compliance with maximum approvals)

Tested components and high efficiency of the heating elements used

Counter tops can be equipped with pass-through ovens, hot cabinets, ventilated, neutral, cantilever and bridge ovens

Also available with plinth

TECHNICAL SPECIFICATIONS

NEUTRAL TOP ELEMENT WITH 2 DRAWERS

CODICE
BN12130215

MODELLO
1100/45TENC

SERIE
SERIE 1100

Technical Information

SPECIFICATION	DATA
MATERIAL	BN12130215
DEFINITION	1100/45 TENC EN TOP C-CAS. 45 110
COMMERCIAL LINE	SERIE 1100
DIM. WIDTH	450 mm
DIM. PRODUCTIVITY	1100 mm
DIM. HEIGHT	280 mm
NET WEIGHT	20 Kg
VOLUME (net)	0,139
PACKAGE LENGTH	510 mm
PACKAGE WIDTH	1280 mm
PACKAGING HEIGHT	620 mm
PACKAGE VOLUME	0,405 m3
GROSS PACKING WEIGHT	42 Kg

NEUTRAL TOP ELEMENT WITH 2 DRAWERS

CODICE
BN12130215

MODELLO
1100/45TENC

SERIE
SERIE 1100

ACCESSORIES

CODE	MODELLO	DESCRIZIONE
110/45B	110/45B	Through-bases 45cm 1000 Series
BN2593510	45/110PDX-SX	Door
CR1355719	CR1355719	Wheel kit
BN2590145	RUB110	Faucet 45x55x62 65 H
BN2592970	CASS45	Drawers for neutral base mod. 45 GN 1/1 h 10 cm 4 drawers
CR1011759	NZA90	FRONT SKIRTING - MODULE 900
CR1011809	NZL110	SIDE PLINTH THROUGH