

# 100 LITRE DIRECT ELECTRIC BOILING PAN

CODICE  
CR1139439T4W

MODELLO  
DT94/10PED10-T4W

SERIE  
DIAMANTE 4.0



## GENERAL CHARACTERISTICS

Diamond 90 Touch 4.0 - Everything under control Everything is under control, perfect results every time. Thanks to the practical display, parameter selection is quick and precise. Easy and clear temperature management, and special functions are always visible and accessible from the display. Tradition and innovation, everything on your worktop A new non-slip square and rounded knob design for a more ergonomic grip and an embossed indicator that makes it easier to select the datum to be set. And with the exclusive Encoder Functionality, simply touch the parameter you want, turn the knob to adjust the level and press it to start the set datum. With water- and dirt-proof crown. Quick and precise parameter selection. Easy and clear temperature management. Special functions always visible and accessible from the display. Stainless steel outer shells and feet. Height from worktop adjustable from 840 to 900 mm. Tops with 2 mm thickness All model-identified equipment (T4W) is 4.0 Ready equipment, allowing you to benefit from all the advantages of connecting your equipment to a cloud system.

## TECHNICAL SPECIFICATIONS

■ AISI 304 stainless steel tanks with AISI 316 bottom. ■ Water loading by means of 2 solenoid valves, with the possibility of loading cold or hot water. ■ Frontal drain by means of 2" chrome-plated brass faucet. ■ Indirect electric version: heating with 2 sets of armoured heating elements positioned inside the cavity. ■ Direct electric version: heating by means of 3 stainless steel heating elements positioned externally on the bottom of the container.

■ Possibility of hot or cold water loading ■ Power level control via touch screen and adjustment with ergonomic knob ■ Stainless steel tank with aisi 316 bottom ■ Possibility of hot or cold water loading ■ industry 4.0 ready version. ■ Everything is under control, perfect results every time. Thanks to the practical display, parameter selection is quick and precise. Easy and clear temperature management, and special functions are always visible and accessible from the display. ■ Thanks to the jet-proofing certification (IPX5) obtained through specific tests, knobs and under-knobs can be washed, without compromising functionality and safety.

## 100 LITRE DIRECT ELECTRIC BOILING PAN

**CODICE**  
CR1139439T4W

**MODELLO**  
DT94/10PED10-T4W

**SERIE**  
DIAMANTE 4.0

### Technical Information

SPECIFICATION	DATA
MATERIAL	CR1139439T4W
SUPPLY	ELECTRICS
STANDARD POWER SUPPLY	380-415V 3N
ELECTRICAL POWER	12 kW
Capacity	100

# 100 LITRE DIRECT ELECTRIC BOILING PAN



weinnovate cooking

CODICE  
CR1139439T4W

MODELLO  
DT94/10PED10-T4W

SERIE  
DIAMANTE 4.0

## SCHEMA DI INSTALLAZIONE - INSTALLATION DIAGRAM - INSTALLATIONSPLAN - SCHÉMA D'INSTALLATION - ESQUEMA DE INSTALACION - INSTALLATIESCHEMA - IINSTALLATIONSRTNINGAR

MISURE IN cm - DIMENSIONS IN cm - ABMESSUNGEN IN cm  
MESURES EN cm - MEDIDAS EN cm - MATEN IN cm

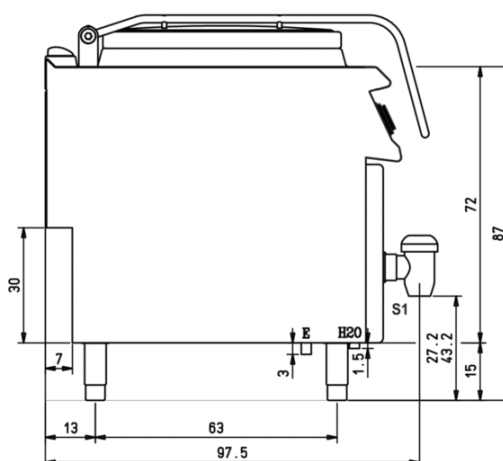
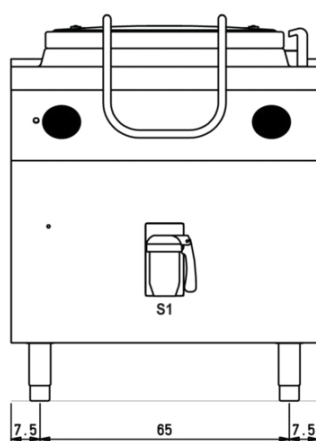

(D) 94/10 PED...

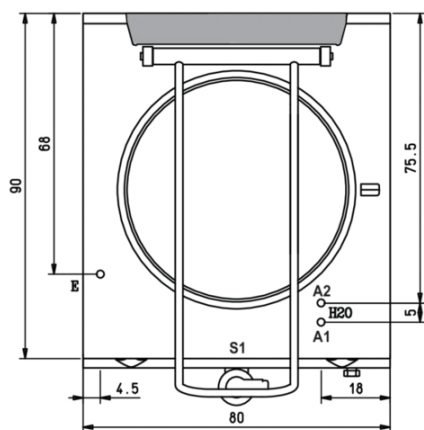

Legenda - Legende - Key - Légende - Leyenda - Legenda

- H20** Attacchi arrivo acqua - Wasseranschluss - Water inlet - Arrivée eau - Union de agua - Wateraansluiting  
**A1** = Calda - Heiss - Warm - Chaude - Caliente - Warm  
**A2** = Fredda - Kalt - Cold - Froid - Fria - Koude  
**EN ISO 228-1 G 3/4**  
**E** Pressacavo entrata linea elettrica - Stopfbuchse - Electric cable stress relief  
 Presse étoupe de câble él. - Pisacable - Elektrische kabelwartel  
**S1** Scarico acqua - Wasserablauf - Water outlet - Vidange de l'eau - Desaguadero - Wateraftapaansluiting  
 2"

## 100 LITRE DIRECT ELECTRIC BOILING PAN

**CODICE**  
CR1139439T4W

**MODELLO**  
DT94/10PED10-T4W

**SERIE**  
DIAMANTE 4.0



Possibility of setting 2 timers to control cooking. An acoustic signal warns the operator at the end of the set time.

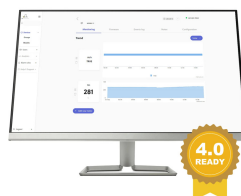

Temperature control via touch screen and adjustment with ergonomic knob



Possibility of hot or cold water loading



Everything is under control, perfect results every time. Thanks to the practical display, parameter selection is quick and precise. Easy and clear temperature management, and special functions are always visible and accessible from the display.



Power level control via touch screen and adjustment with ergonomic knob



Thanks to the jet-proofing certification (IPX5) obtained through specific tests, knobs and under-knobs can be washed, without compromising functionality and safety.



Stainless steel tank with aisi 316 bottom

## 100 LITRE DIRECT ELECTRIC BOILING PAN

CODICE  
CR1139439T4W

MODELLO  
DT94/10PED10-T4W

SERIE  
DIAMANTE 4.0

### ACCESSORIES

CODE	MODELLO	DESCRIZIONE
CR1357499	4.0IOTPRO	PRO Subscription - Cloud
CR1357479	4.0IOTENTRY	ENTRY Subscription - Cloud
MA97350900	9C10	COLANDER BASKET
MA97352000	9CV10	VEGETABLE STRAINER BASKET FOR POT
MA97354000	9-I10	FUNNEL FOR POT DISCHARGE