

DISH RACK

CODICE
BNN27065134

MODELLO
NPP613SC

SERIE
PREPARATION



GENERAL CHARACTERISTICS

Indispensable for a functional kitchen, the preparation range offers a wide choice of models for preparation. The tables on legs, cabinets, with drawers, sinks, wall units and dish cupboards are all made of stainless steel. The care in the workmanship guarantees an excellent combination of elements and easy cleaning.

Indispensable for a functional kitchen, the preparation range offers a wide choice of models for preparation. The tables on legs, cabinets, with drawers, sinks, wall units and dish cupboards are all made of stainless steel. The care in the workmanship guarantees an excellent combination of elements and easy cleaning.

TECHNICAL SPECIFICATIONS

■ AISI 430 STAINLESS STEEL OPEN TOP

With adjustable intermediate shelf ■ CLOSED IN STAINLESS STEEL AISI 430

With adjustable intermediate shelf, PERFORATED in models with drainer, with doors ■ SLIDING

Front with recessed handle with inside counter door, upper slide with bearings. Bottom slide with PVC skid on PVC double-channel guides ■

SASHES

Front with recessed handle, with inside counter door, magnet closure and rotary opening

■ Scotch-Brite stainless steel execution. Removable water draining shelf.

Perforated bottom. Complete with brackets for wall mounting.

DISH RACK

CODICE
BNN27065134

MODELLO
NPP613SC

SERIE
PREPARATION

Technical Information

SPECIFICATION	DATA
MATERIAL	BNN27065134
DEFINITION	PENSILE SCOLAPIATTI EPP613SC/FS
SUPPLY	NO
DIM. WIDTH	1300 mm
DIM. PRODUCTIVITY	400 mm
DIM. HEIGHT	650 mm
NET WEIGHT	37 Kg
VOLUME (net)	0.405
PACKAGE LENGTH	1350 mm
PACKAGE WIDTH	600 mm
PACKAGING HEIGHT	500 mm
PACKAGE VOLUME	0,405 m3
GROSS PACKING WEIGHT	45 Kg
CERTIFIED MODEL	EPP613SC

DISH RACK

CODICE
BNN27065134

MODELLO
NPP613SC

SERIE
PREPARATION

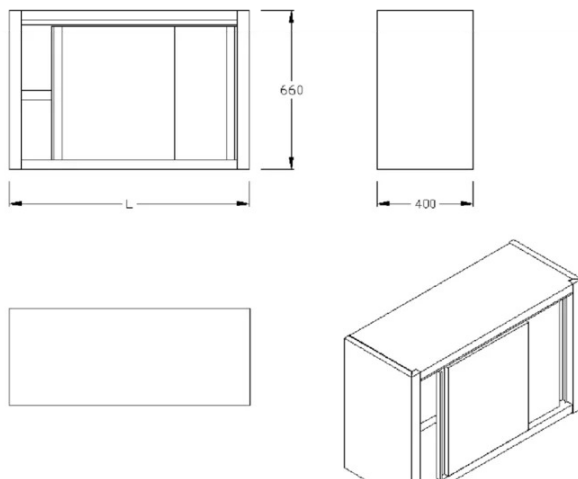

Wall connection :



The company declines all responsibility for possible printing errors, guarding herself the right to make changes to dimensions and specifications, if necessary, without notice.