

REFRIGERATED TABLE (4 DOORS TEMP -2/+8°C) TOP WITH SPLASHBACK

CODICE

BN26WC0212104HZT4W

MODELLO

OOW04PA-T4W

SERIE

DIAMANTE 4.0



GENERAL CHARACTERISTICS

Diamond 90 Touch 4.0 - Everything under control Everything is under control, perfect results every time. Thanks to the practical display, parameter selection is quick and precise. Easy and clear temperature management, and special functions are always visible and accessible from the display. Tradition and innovation, everything on your worktop A new non-slip square and rounded knob design for a more ergonomic grip and an embossed indicator that makes it easier to select the datum to be set. And with the exclusive Encoder Functionality, simply touch the parameter you want, turn the knob to adjust the level and press it to start the set datum. With water- and dirt-proof crown. Quick and precise parameter selection. Easy and clear temperature management. Special functions always visible and accessible from the display. Stainless steel outer shells and feet. Height from worktop adjustable from 840 to 900 mm. Tops with 2 mm thickness All model-identified equipment (T4W) is 4.0 Ready equipment, allowing you to benefit from all the advantages of connecting your equipment to a cloud system.

TECHNICAL SPECIFICATIONS

■ O-RANGE W REFRIGERATED TABLES WITH 4.0 READY MOTOR ■ OLIS refrigerated tables are made with a state-of-the-art system to preserve food in a healthy way and ensure greater and overall efficiency of the facility. Automatic door closure with magnetic gasket ensures total safety, maximum quality and hygiene of every prepared product. ■ Moulded cell bottom with rounded edges and removable grid

supports for maximum hygiene and loading flexibility ■ Insulation thickness of 60 mm, made of high-density polyurethane foam, totally CFC-free ■ Ducted ventilation system to even out internal temperature ■ Environmentally friendly refrigerant R290

REFRIGERATED TABLE (4 DOORS TEMP -2/+8°C) TOP WITH SPLASHBACK

CODICE	MODELLO	SERIE
BN26WC0212104HJT4W	OOW04PA-T4W	DIAMANTE 4.0

Technical Information

SPECIFICATION	DATA
MATERIAL	BN26WC0212104HJT4W
DEFINITION	OOW04PA-T4W R290DX TNN PSPDPSPD C/A50SV
NET WEIGHT	117 Kg
PACKAGE LENGTH	2240 mm
PACKAGE WIDTH	750 mm
PACKAGING HEIGHT	1060 mm
PACKAGE VOLUME	1,781 m3
GROSS PACKING WEIGHT	137 Kg
STANDARD POWER SUPPLY	220-240V 1N

REFRIGERATED TABLE (4 DOORS TEMP -2/+8°C)
TOP WITH SPLASHBACK

CODICE	MODELLO	SERIE
BN26WC0212104HZT4W	OOW04PA-T4W	DIAMANTE 4.0

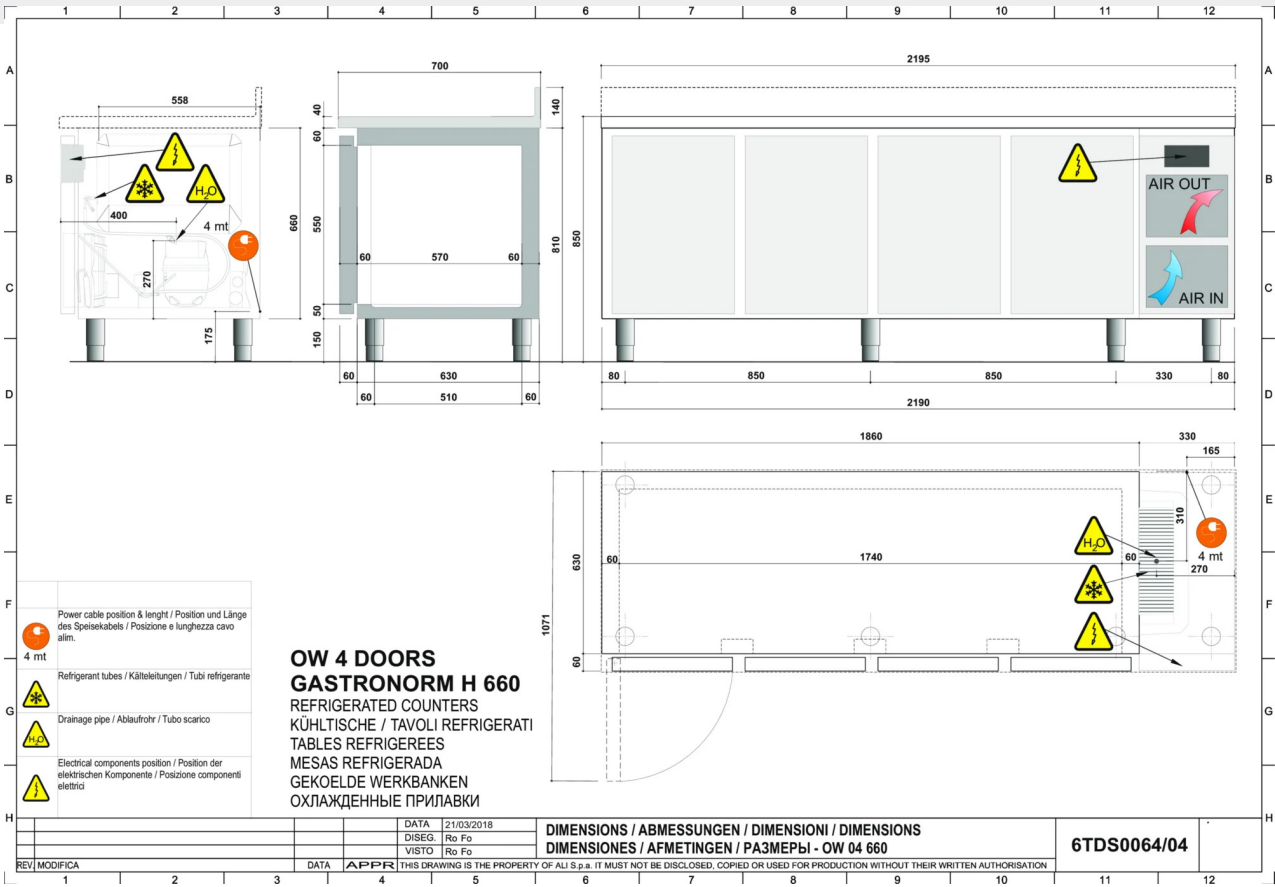

REFRIGERATED TABLE (4 DOORS TEMP -2/+8°C)
TOP WITH SPLASHBACK

CODICE	MODELLO	SERIE
BN26WC0212104HZT4W	OOW04PA-T4W	DIAMANTE 4.0

ACCESSORIES

CODE	MODELLO	DESCRIZIONE
CR1357499	4.0IOTPRO	PRO Subscription - Cloud
CR1357479	4.0IOTENTRY	ENTRY Subscription - Cloud