

# MULTIFUNCTION FIT PAN SLIM GN1/1

CODICE  
CR0999049

MODELLO  
D74/10MAE

SERIE  
DIAMANTE 70



## GENERAL CHARACTERISTICS

In addition to offering the widest choice of solutions and 2 mm thick and 70 cm deep tops, this series has all the power, robustness and functionality you need to work efficiently. Scotch Brite finish stainless steel outer shells and feet. Worktop height adjustable from 840 to 900 mm. Modularity of range: 200-400-600-800-1200. Wide range of accessories.

## TECHNICAL SPECIFICATIONS

■ Automatic water filling with the possibility of programming litres. ■ Mains water drain with overflow drain and basin drain hole with sealing plug. ■ Control of cooking by core probe. ■ Easy to

understand and use Touch Screen control panel. Possibility of storing personal recipes. ■ Basin for draining the cooked product into the tank. Guaranteed cleanliness of the station and easy transport of products.

# MULTIFUNCTION FIT PAN SLIM GN1/1

CODICE  
CR0999049

MODELLO  
D74/10MAE

SERIE  
DIAMANTE 70

## Technical Information

| SPECIFICATION                | DATA                               |
|------------------------------|------------------------------------|
| <b>MATERIAL</b>              | <b>CR0999049</b>                   |
| DEFINITION                   | D74/10MAE MULTI COOKER FITPAN OLIS |
| <b>COMMERCIAL LINE</b>       | <b>DIAMANTE</b>                    |
| SUPPLY                       | ELECTRICS                          |
| <b>DIM. WIDTH</b>            | <b>400 mm</b>                      |
| DIM. PRODUCTIVITY            | 700 mm                             |
| <b>DIM. HEIGHT</b>           | <b>870 mm</b>                      |
| NET WEIGHT                   | 103 Kg                             |
| <b>VOLUME (net)</b>          | <b>0,244</b>                       |
| PACKAGE LENGTH               | 840 mm                             |
| <b>PACKAGE WIDTH</b>         | <b>850 mm</b>                      |
| PACKAGING HEIGHT             | 1170 mm                            |
| <b>PACKAGE VOLUME</b>        | <b>0,836 m3</b>                    |
| GROSS PACKING WEIGHT         | 116 Kg                             |
| <b>STANDARD POWER SUPPLY</b> | <b>380-415V 3N</b>                 |
| FREQUENCY                    | 50-60 Hz                           |
| <b>ELECTRICAL POWER</b>      | <b>10,000 kW</b>                   |
| IP GRADE                     | IPX4                               |

# MULTIFUNCTION FIT PAN SLIM GN1/1

CODICE  
CR0999049

MODELLO  
D74/10MAE

SERIE  
DIAMANTE 70

MISURE IN cm - DIMENSIONS IN cm - ABMESSUNGEN IN cm- MESURES EN cm  
MEDIDAS EN cm - MATEN IN cm - DIMENSIONES EN cm

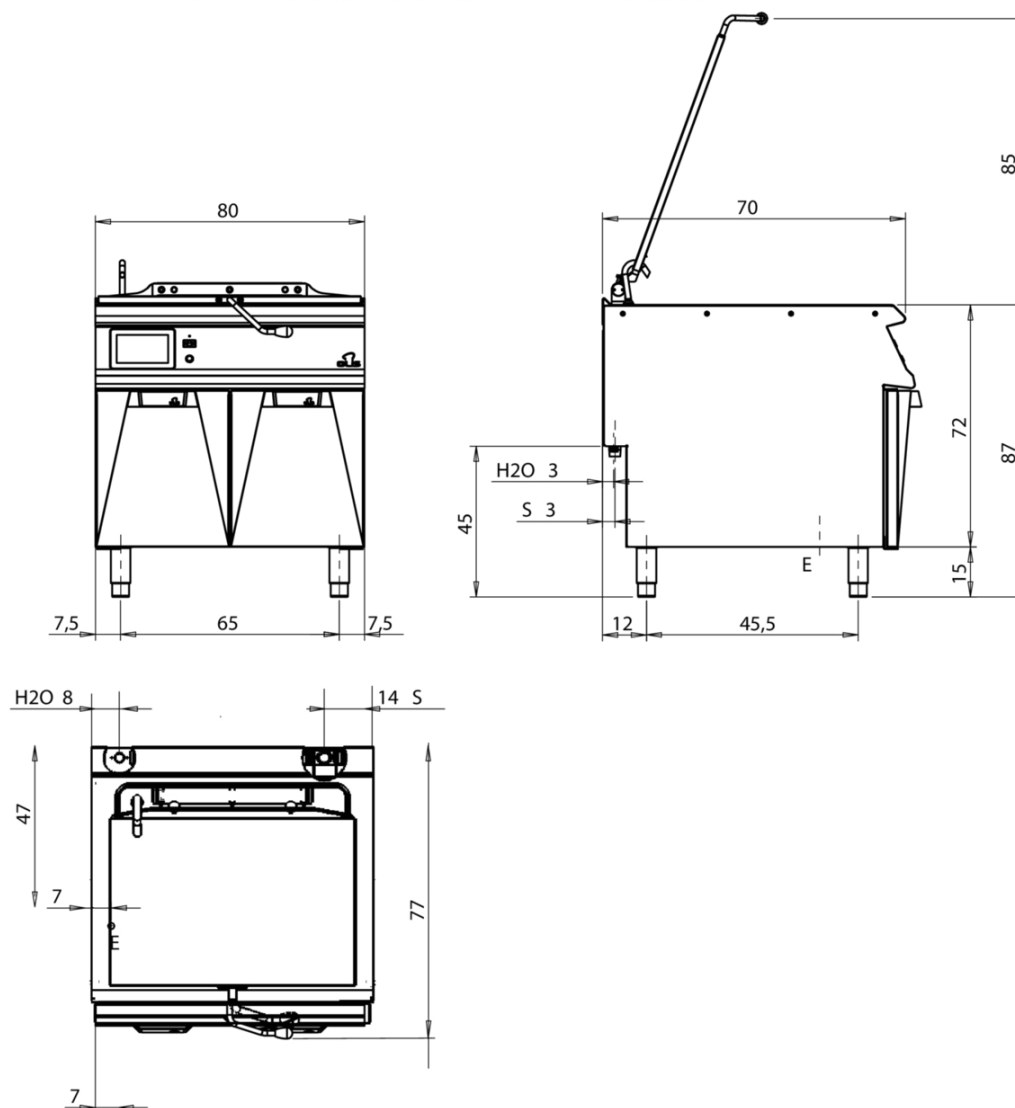

## Legenda - Legende - Key - Légende - Leyenda - Legenda - Legenda

|    |   |      |   |
|----|---|------|---|
| E  | Pressacavo entrata linea elettrica - Stopfbuchse - Electric cable stress relief - Presse étoupe de câble él - Pisacable - Elektrische kabelwartel - Entrada cabo eléctrico  | G    | Arrivo gas - Gasanschluss - Gas connection - Arrivée gaz - Union de gas - Gasaansluiting - Ligação gás                  |
| S  | Attacco scarico acqua - Wasserablauf - Water outlet - Vidange de l'eau - Desaguadero - Wateraftapaansluiting - Junção descarga água UNI EN 10226-1 R 1"   | H20  | Arrivo acqua - Wasseranschluss - Water inlet - Arrivée eau - Union de agua - Wateraansluiting - Junção alimentação água |
| S1 | Scarico vasca - Wannenabflussrohr - Pan outlet - Vidange du bac - Descarga cuba - Water toevoer - Descarga da cuba  | A1 = | Calda - Heiss - Warm - Chaud - Caliente - Warm - Morno  |
| S2 | Valvola di depressione - Anti-depression valve - Unterdruck ventil - Soupape de dépression - Válvula de depresión - Onderdrukklep - Válvula de depressão  | A2 = | Fredda - Kalt - Cold - Froid - Fria - Koude - Frio  |
| S3 | Scarico acqua intercapedine - Wasserablauf Zwischenraum - Jacket water drain Evacuation eau double envelope - Descarga de agua intersticios - Afvoer water tussenruimte - Descarga de água na marmitta com Sistema de aquecimento indirecto |      | EN ISO 228-1 G3/4   |
| S4 | Scarico - Abflussrohr - Drain - Tuyau d'évacuation - Tubo de drenaje - Aftapbuis - Tubulação de dreno   | L    | Rubinetto di livello - Level tap - Wasserhahn - Robinet de niveau - Grifo de nivel - Niveaukraan - Torneira de nível    |

## MULTIFUNCTION FIT PAN SLIM GN1/1

CODICE  
CR0999049

MODELLO  
D74/10MAE

SERIE  
DIAMANTE 70



Automatic water filling with the possibility of programming litres.



Basin for draining the cooked product into the tank. Guaranteed cleanliness of the station and easy transport of products.

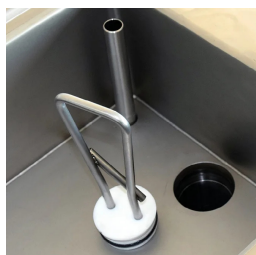

Mains water drain with overflow drain and basin drain hole with sealing plug.

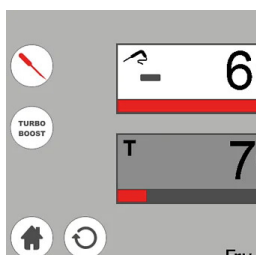

Control of cooking by core probe.

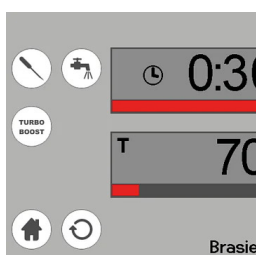

Easy to understand and use Touch Screen control panel. Possibility of storing personal recipes.

## MULTIFUNCTION FIT PAN SLIM GN1/1

CODICE  
CR0999049

MODELLO  
D74/10MAE

SERIE  
DIAMANTE 70

### ACCESSORIES

| CODE      | MODELLO   | DESCRIZIONE                           |
|-----------|-----------|---------------------------------------|
| CR1200179 | CAMCF     | Lid for steamer use                   |
| CR1200169 | GFMCF     | Tank bottom grid                      |
| CR1200159 | CPC1/3MCF | GN1/3 basket for pasta cooker         |
| CR1200119 | TSCMCF    | Frame for slow cooking                |
| CR0956330 | SDXP      | Shovel                                |
| CR0999069 | CRLMCF    | Trolley for multifunctional           |
| CR1200149 | CV1/3MCP  | GN1/3 steamer basket 160x280x115(H)cm |