

INDIRECT ELECTRIC BOILING PAN 50 lt WITH AUTOMATIC CONDENSATE DRAIN VALVE

CODICE
CR1356079

MODELLO
D73/10PEI05S

SERIE
DIAMANTE 70



GENERAL CHARACTERISTICS

In addition to offering the widest choice of solutions and 2 mm thick and 70 cm deep tops, this series has all the power, robustness and functionality you need to work efficiently. Scotch Brite finish stainless steel outer shells and feet. Worktop height adjustable from 840 to 900 mm. Modularity of range: 200-400-600-800-1200. Wide range of accessories.

TECHNICAL SPECIFICATIONS

■ Possibility of hot or cold water loading ■ Stainless steel tank with aisi 316 bottom ■ Indirect pans with automatic condensate drain valve ■ Equipment certified for low voltage directive 2014/35/EU

according to the international CB scheme. ■ Thanks to the jet-proofing certification obtained in specific tests, the knobs and under-knobs can be washed, without compromising functionality and safety.

INDIRECT ELECTRIC BOILING PAN 50 lt WITH AUTOMATIC CONDENSATE DRAIN VALVE

CODICE
CR1356079

MODELLO
D73/10PEI05S

SERIE
DIAMANTE 70

Technical Information

SPECIFICATION	DATA
MATERIAL	CR1356079
DEFINITION	D73/10 PEI05 S PEN.ELE IND.M60 C/VAL 50L
COMMERCIAL LINE	DIAMANTE
SUPPLY	ELECTRICS
DIM. WIDTH	600 mm
DIM. PRODUCTIVITY	730 mm
DIM. HEIGHT	870 mm
NET WEIGHT	95 Kg
VOLUME (net)	0,381
PACKAGE LENGTH	660 mm
PACKAGE WIDTH	850 mm
PACKAGING HEIGHT	1240 mm
PACKAGE VOLUME	0,695 m3
GROSS PACKING WEIGHT	105 Kg
STANDARD POWER SUPPLY	380-415V 3N
FREQUENCY	50-60 Hz
ELECTRICAL POWER	9,800 kW
IP GRADE	IPX4
CERTIFIED MODEL	D73/10 PEI05
Capacity	50 litri

INDIRECT ELECTRIC BOILING PAN 50 lt WITH AUTOMATIC CONDENSATE DRAIN VALVE

CODICE
CR1356079

MODELLO
D73/10PEI05S

SERIE
DIAMANTE 70

SCHEMA DI INSTALLAZIONE - INSTALLATION DIAGRAM - INSTALLATIONSPLAN - SCHÉMA D'INSTALLATION - ESQUEMA DE INSTALACION - INSTALLATIESCHEMA - IINSTALLATIONSRIJNINGAR

MISURE IN cm - DIMENSIONS IN cm - ABMESSUNGEN IN cm
MESURES EN cm - MEDIDAS EN cm - MATEN IN cm

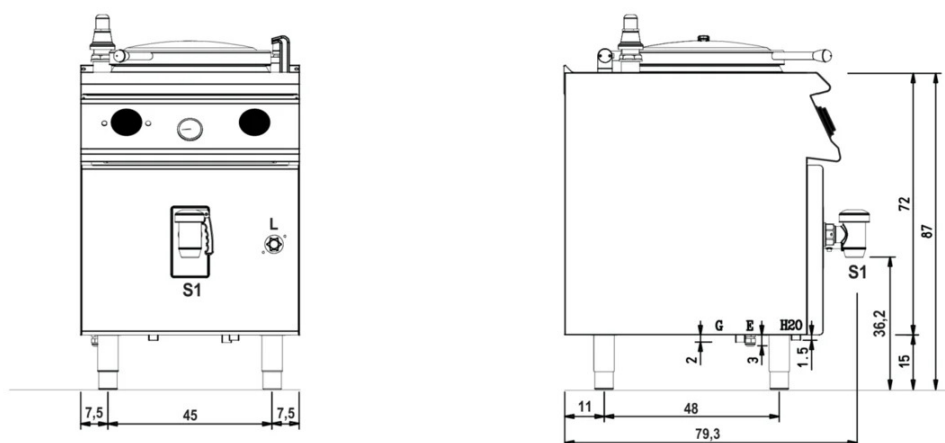

(D) 73/10 PEI05

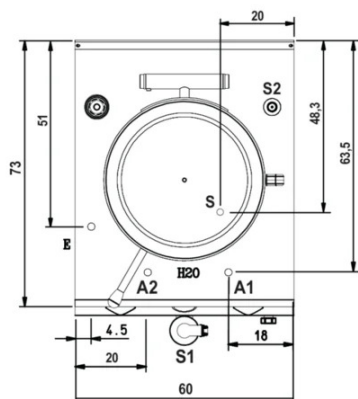

Legenda - Legende - Key - Légende - Leyenda - Legenda

- H2O** Attacchi arrivo acqua - Wasseranschluss - Water inlet - Arrivée eau - Union de agua - Wateraansluiting
A1 = Calda - Heiss - Warm - Chaude - Caliente - Warm
A2 = Fredda - Kalt - Cold - Froid - Fria - Koude
EN ISO 228-1 G 3/4
E Pressacavo entrata linea elettrica - Stopfbuchse - Electric cable stress relief
 Presse étoupe de câble él. - Pisacable - Elektrische kabelwartel
S Scarico acqua intercapedine - Wasserablauf Zwischenraum - Jacket water drain
 Evacuation eau double enveloppe - Descarga de agua intersticios - Afvoer water tussenruimte
EN ISO 10226-1 R 3/4
S1 Scarico acqua - Wasserablauf - Water outlet - Vidange de l'eau - Desaguadero - Wateraftapaansluiting
 1 1/2"

INDIRECT ELECTRIC BOILING PAN 50 lt WITH AUTOMATIC CONDENSATE DRAIN VALVE

CODICE
CR1356079

MODELLO
D73/10PEI05S

SERIE
DIAMANTE 70



Possibility of hot or cold water loading



Thanks to the jet-proofing certification (IPX5) obtained through specific tests, knobs and under-knobs can be washed, without compromising functionality and safety.



Stainless steel tank with aisi 316 bottom



Indirect pans with automatic condensate drain valve

Equipment certified for low voltage directive 2014/35/EU according to the international CB scheme.



INDIRECT ELECTRIC BOILING PAN 50 lt WITH AUTOMATIC CONDENSATE DRAIN VALVE

CODICE
CR1356079

MODELLO
D73/10PEI055

SERIE
DIAMANTE 70

ACCESSORIES

CODE	MODELLO	DESCRIZIONE
MA97347000	9C5	COLANDER BASKET
MA97348000	9CV5	VEGETABLE STRAINER BASKET FOR POT
CR0599730	7C8	COLAPASTA BASKET - 80 Lt. HOLES Ø 3 MM - 1 SECTOR
CR0599740	7CV8	COOLING BOWL FOR POTS - 80 Lt. HOLES Ø 6 MM - 1 SECTOR
CR0592789	ZF6	Front plinth - FOR INSTALLING EQUIPMENT WITH FLOOR HEIGHT 90 CM L=60
CR0592830	ZG	SKIRTING JOINT
MA97432000	R	WHEEL KIT (2 + 2) Ø 100
MA97433000	RI	WHEEL KIT (2 + 2) Ø 101 STAINLESS STEEL
CR0592869	PZM	NO. 4 STAINLESS STEEL FEET FOR INSTALLATION ON CONCRETE PLINTH
CR0593580	9PT	No. 4 stainless steel feet for installation on tops
CR0592879	KPA	N.2 STAINLESS STEEL FEET WITH FLANGE
CR0599649	7ZL	Side plinth
MA97349000	9-I5	POWDER DISCHARGE INSTALLATION-50 Lt. HOLES Ø 10-15-36 MM