

BASKET LIFTER

CODICE
CR0990609

MODELLO
D90/10SCCP

SERIE
DIAMANTE 90

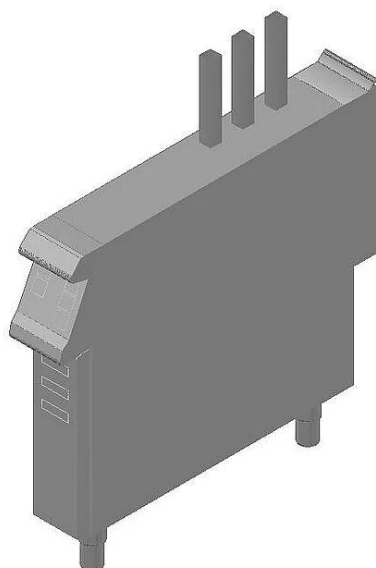

GENERAL CHARACTERISTICS

In addition to offering the maximum choice of solutions and 2 mm thick and 90 cm deep tops, this series has all the power, robustness and functionality you need to work efficiently. External coatings and feet in stainless steel with Scotch Brite finish. Working table height adjustable from 840 to 900 mm. Range modularity: 200-400-600-800-1200 Wide range of accessories.

TECHNICAL SPECIFICATIONS

■ Moulded tubs with rounded corners, made of AISI 316 stainless steel for maximum corrosion resistance. ■ Water filling available by means of solenoid valve with the possibility of fast or slow loading or by means of a mechanical tap located on the control panel. Stainless steel water outlet integrated in the expansion zone, and floor drain. ■ Safety pressure switch to prevent activation of heating without water in the tank. ■ Gas version: Heating via stainless steel burner positioned outside the tank. ■ Safety gas valve with thermocouple and electric

ignition. ■ Electric version: Heating by means of an AISI 304 steel armoured heating element located in the tank and rotatable by 90° for easy cleaning.

■ Thanks to the jet-proofing certification (IPX5) obtained through specific tests, knobs and under-knobs can be washed, without compromising functionality and safety.

BASKET LIFTER

CODICE
CR0990609

MODELLO
D90/10SCCP

SERIE
DIAMANTE 90

Technical Information

SPECIFICATION	DATA
MATERIAL	CR0990609
DEFINITION	D90/10 SCCP MODULO SOLLEVACESTINI CUOC.
COMMERCIAL LINE	DIAMANTE
SUPPLY	ELECTRICS
DIM. WIDTH	200 mm
DIM. PRODUCTIVITY	900 mm
DIM. HEIGHT	870 mm
NET WEIGHT	54.4 Kg
VOLUME (net)	0,157
PACKAGE LENGTH	460 mm
PACKAGE WIDTH	1020 mm
PACKAGING HEIGHT	1150 mm
PACKAGE VOLUME	0,540 m3
GROSS PACKING WEIGHT	65 Kg
STANDARD POWER SUPPLY	220-240V 1N
FREQUENCY	50 Hz
ELECTRICAL POWER	0,065 kW
IP GRADE	IPX5
CERTIFIED MODEL	D90/10 SCCP

BASKET LIFTER

CODICE
CR0990609

MODELLO
D90/10SCCP

SERIE
DIAMANTE 90



Thanks to the jet-proofing certification (IPX5) obtained through specific tests, knobs and under-knobs can be washed, without compromising functionality and safety.